

**9 | WALL 09 - 1 HR LOADBEARING WALL**  
1 1/2" = 1'-0"

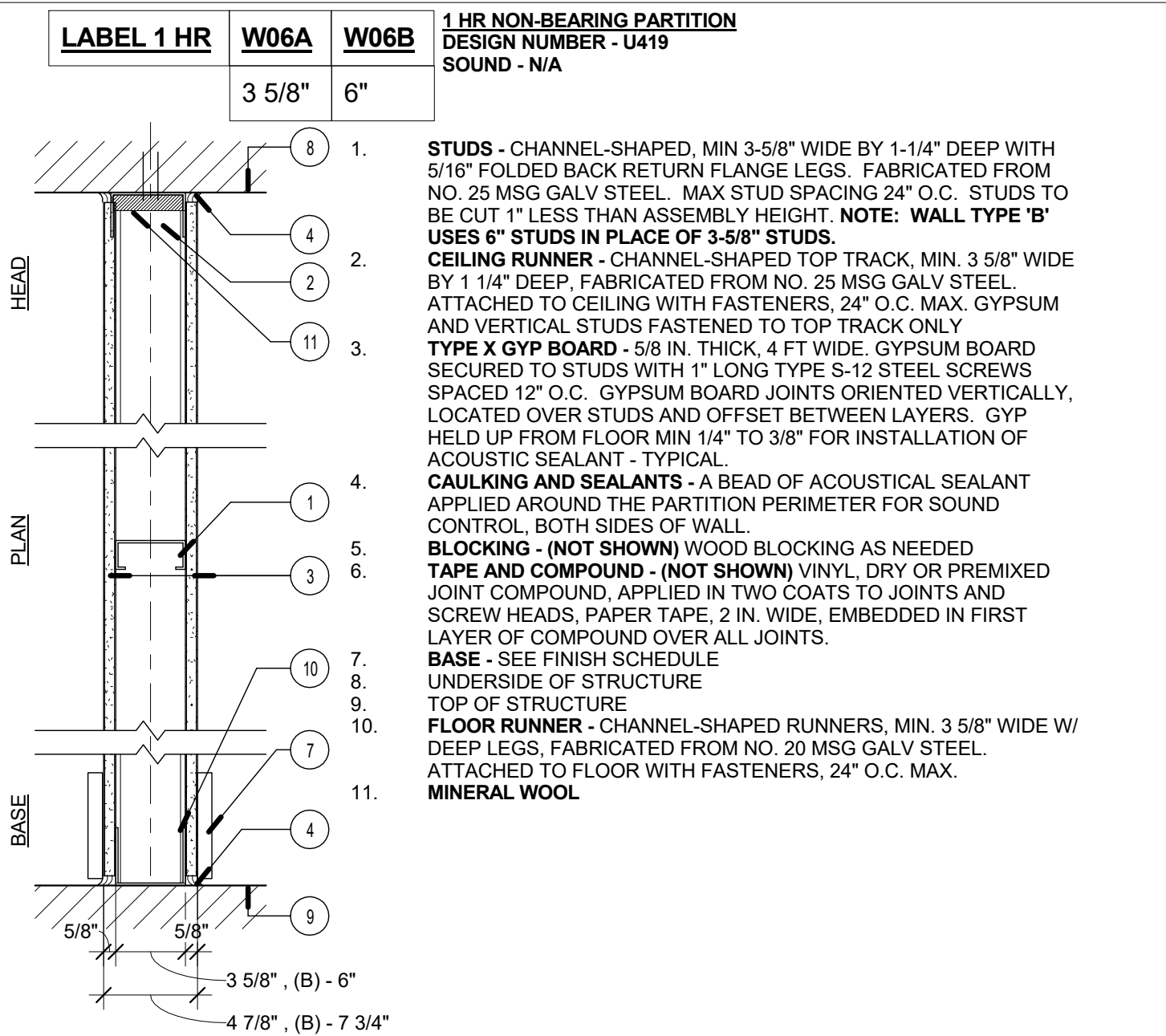

**6 | WALL 06A&B - NON RATED PARTITION**  
1 1/2" = 1'-0"

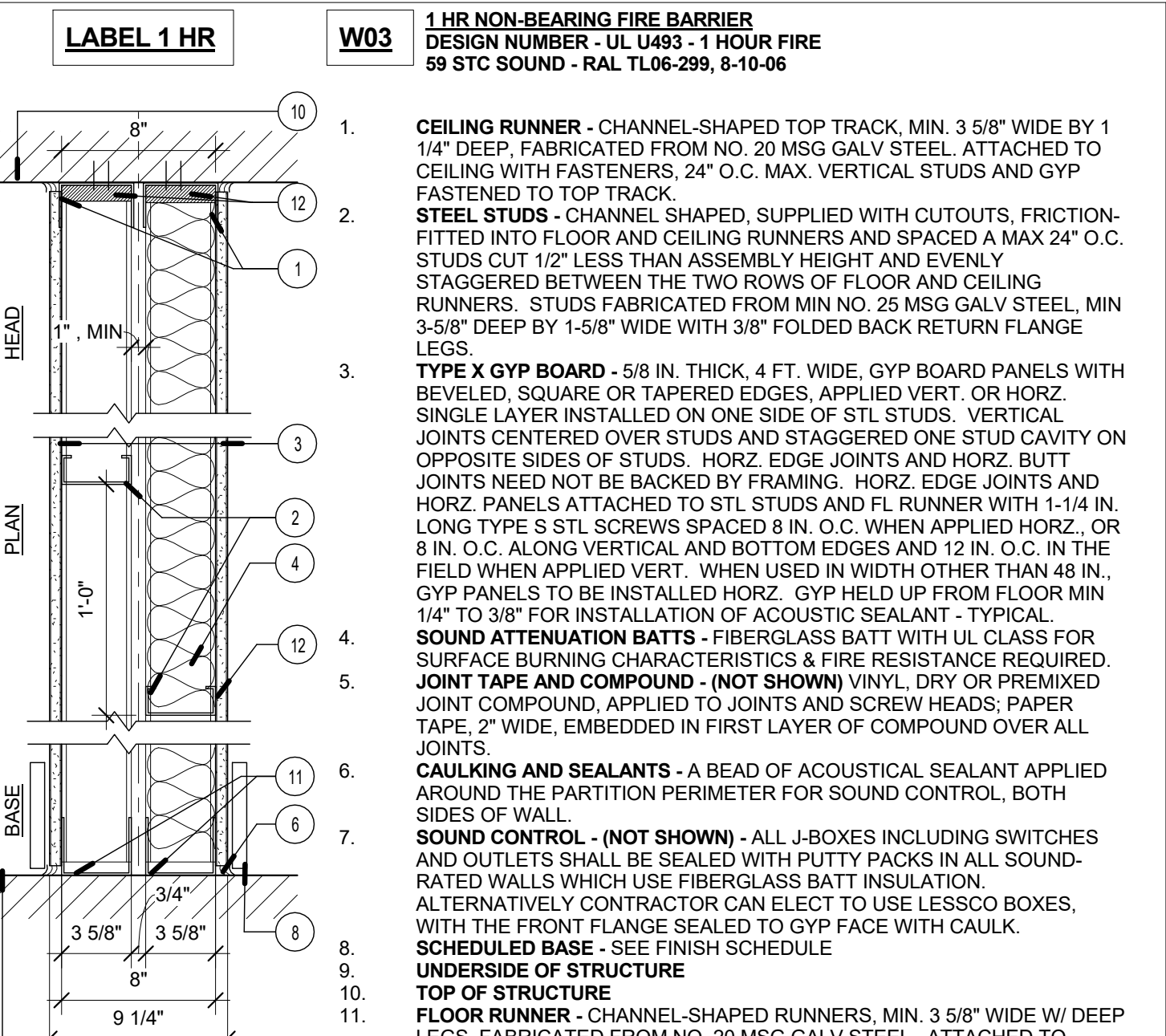

**2 | WALL 03 - DEMISING WALL**  
1 1/2" = 1'-0"

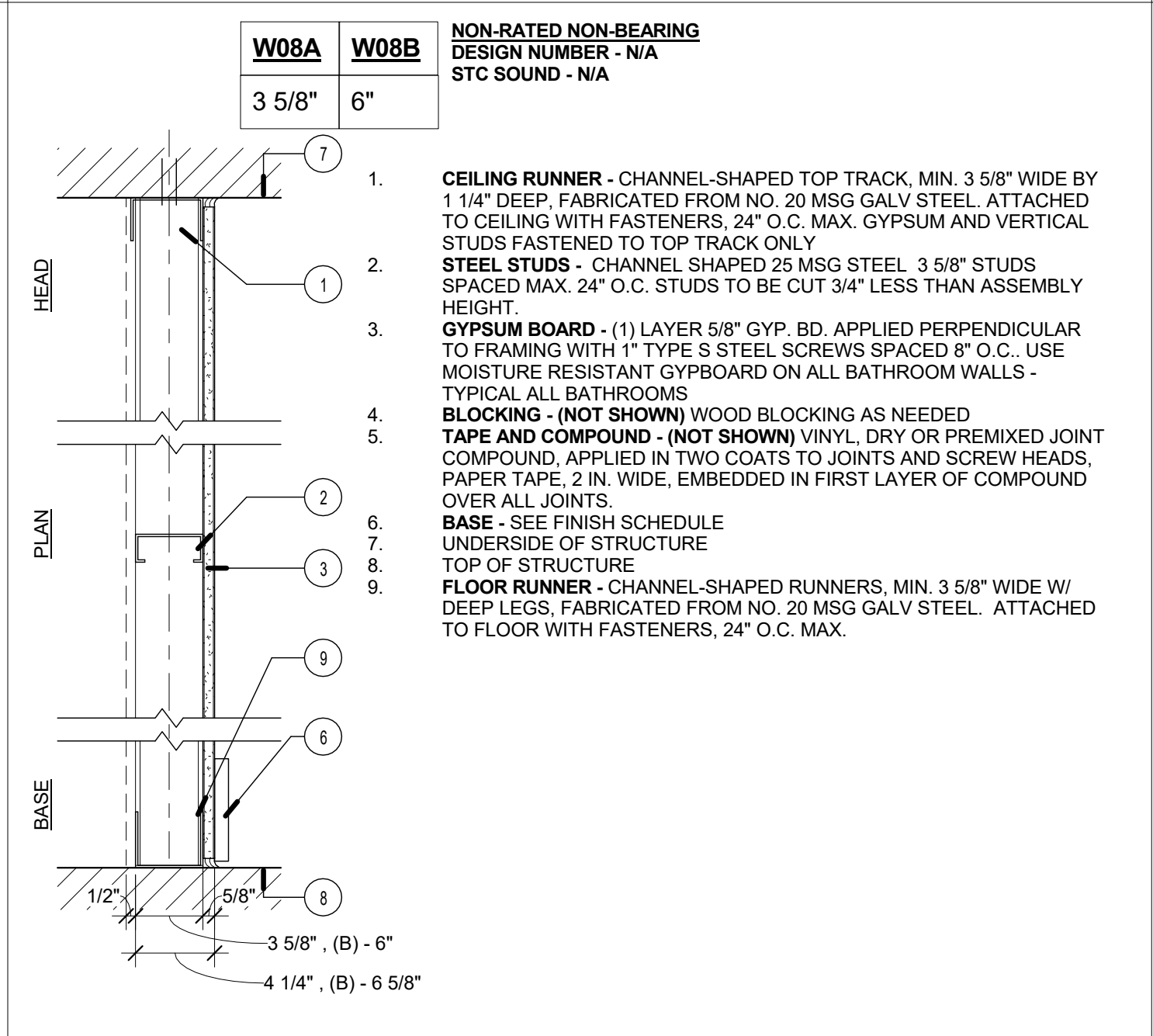

**8 | WALL 08A&B - NON-RATED ONE-SIDED PARTITION**  
1 1/2" = 1'-0"

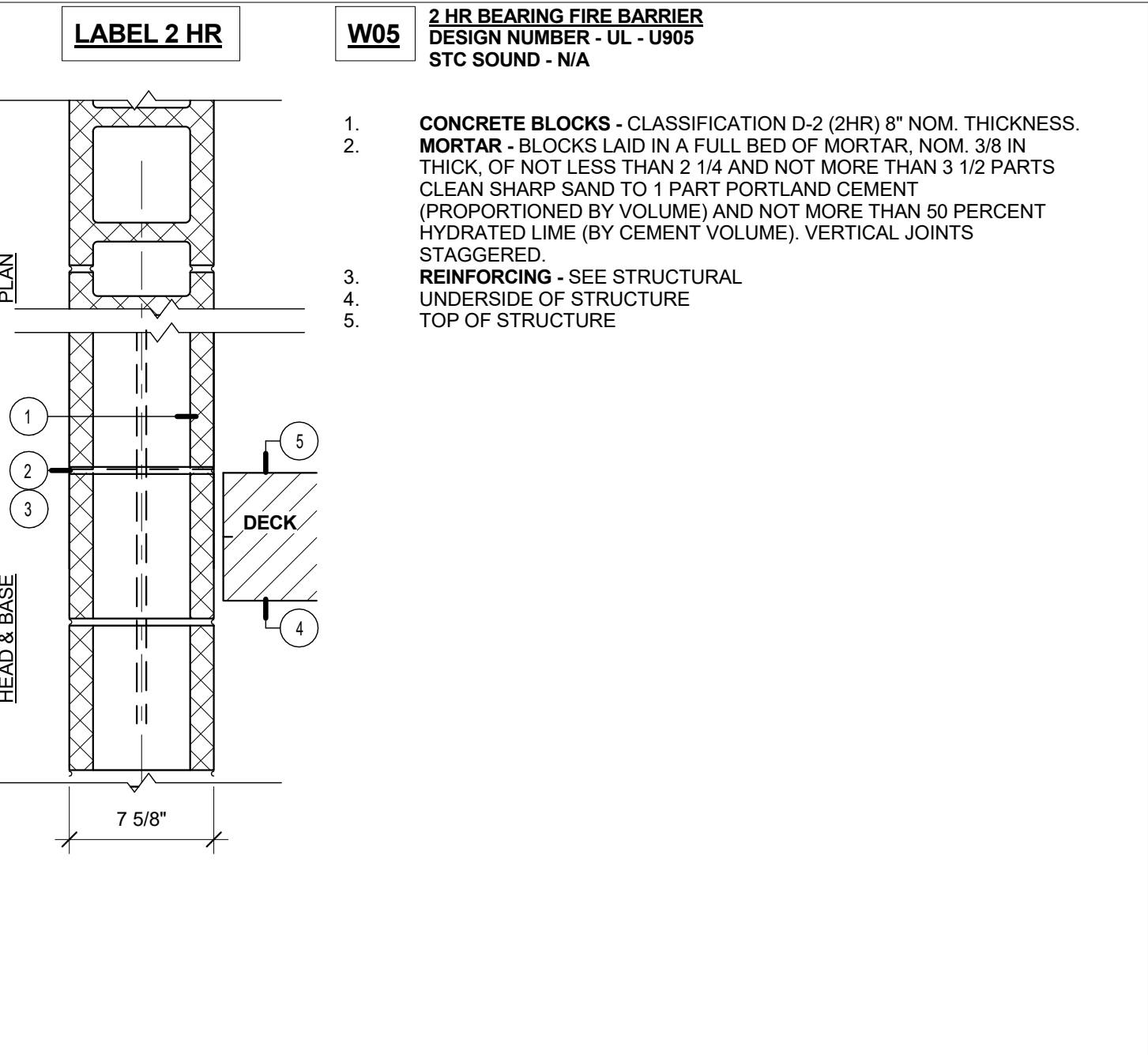

**5 | WALL 05 - CMU**  
1 1/2" = 1'-0"

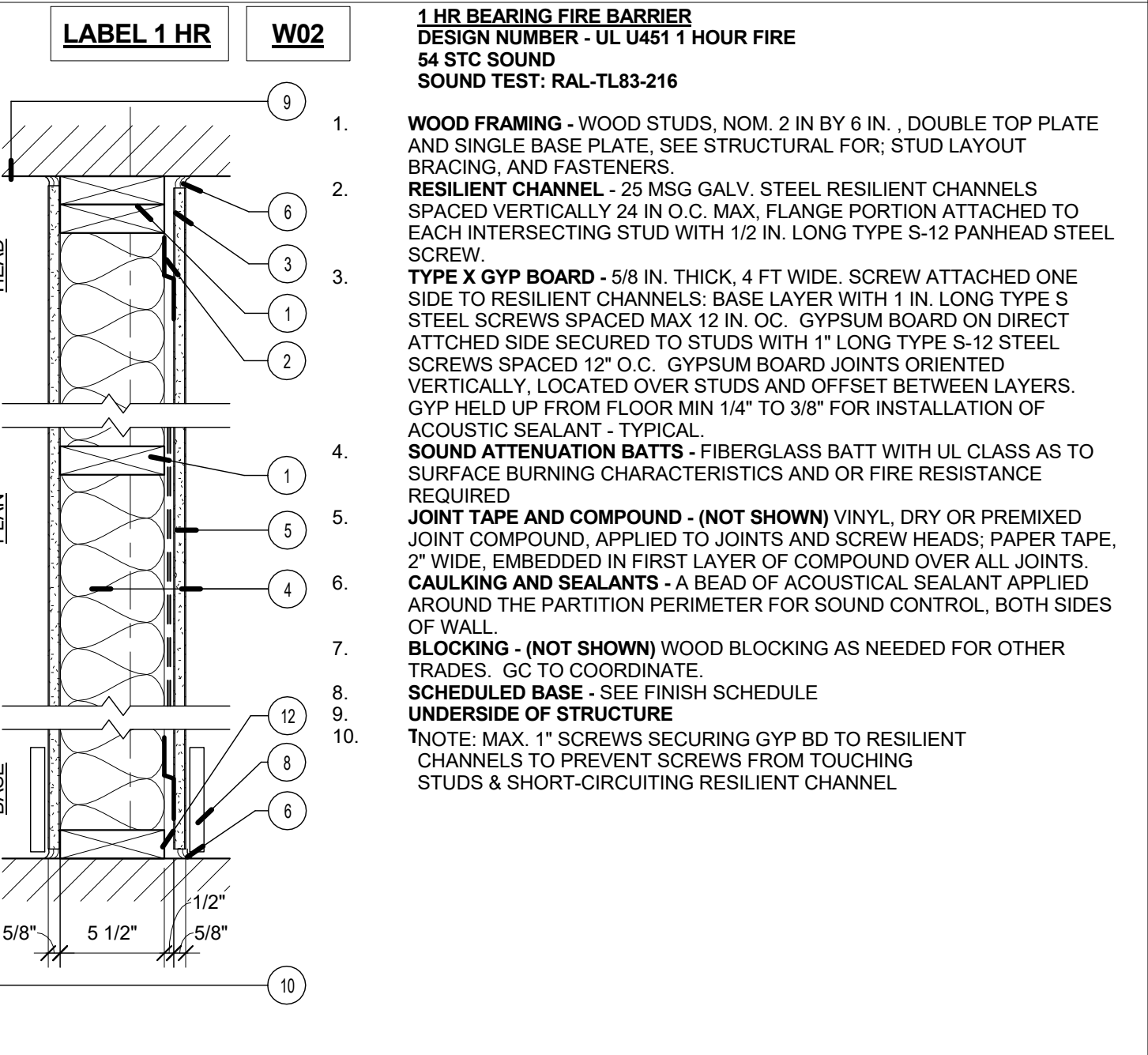

**3 | WALL 02 - CORRIDOR BEARING WALL**  
1 1/2" = 1'-0"

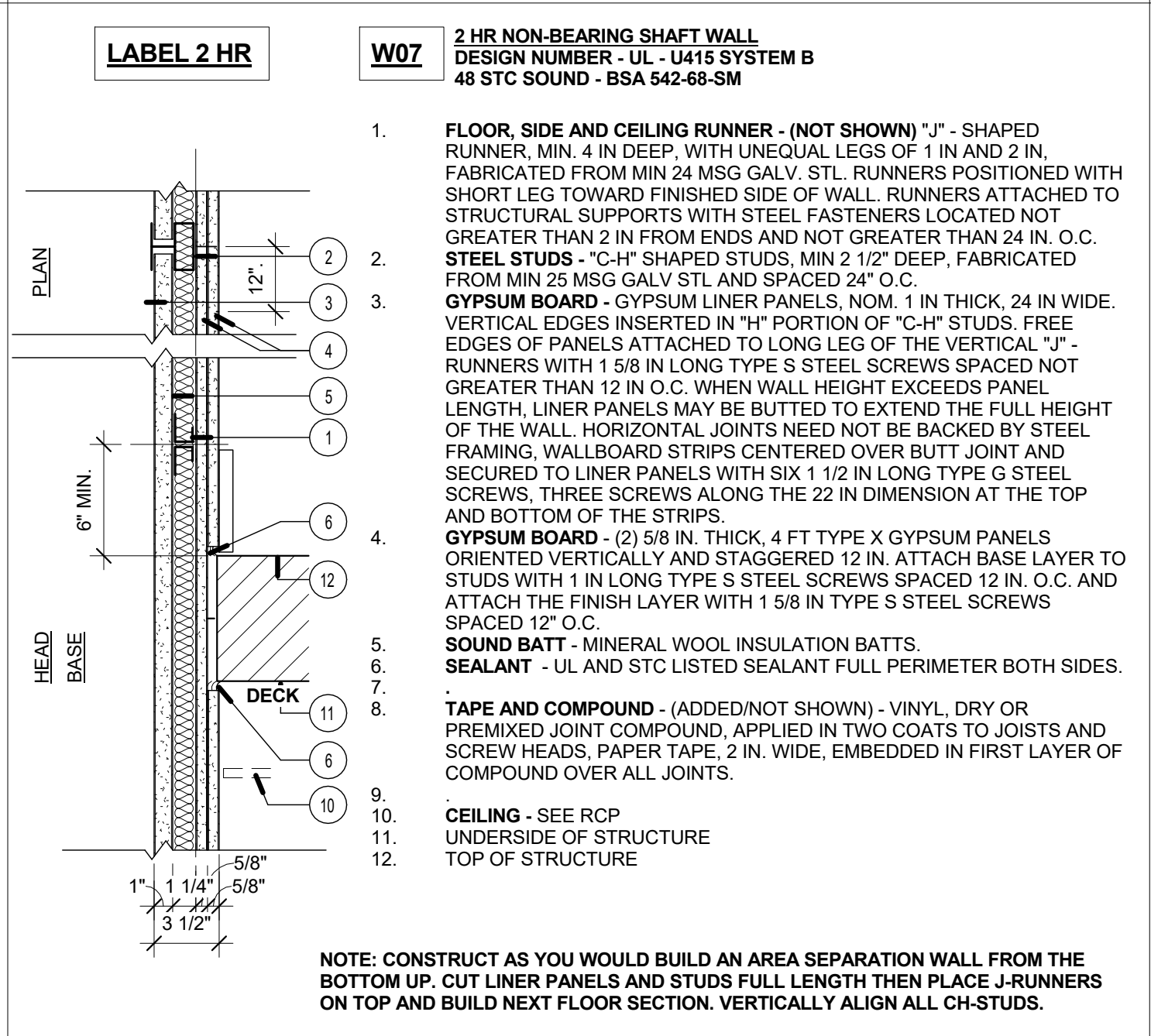

**7 | WALL 07 - SHAFT WALL ASSEMBLY**  
1 1/2" = 1'-0"

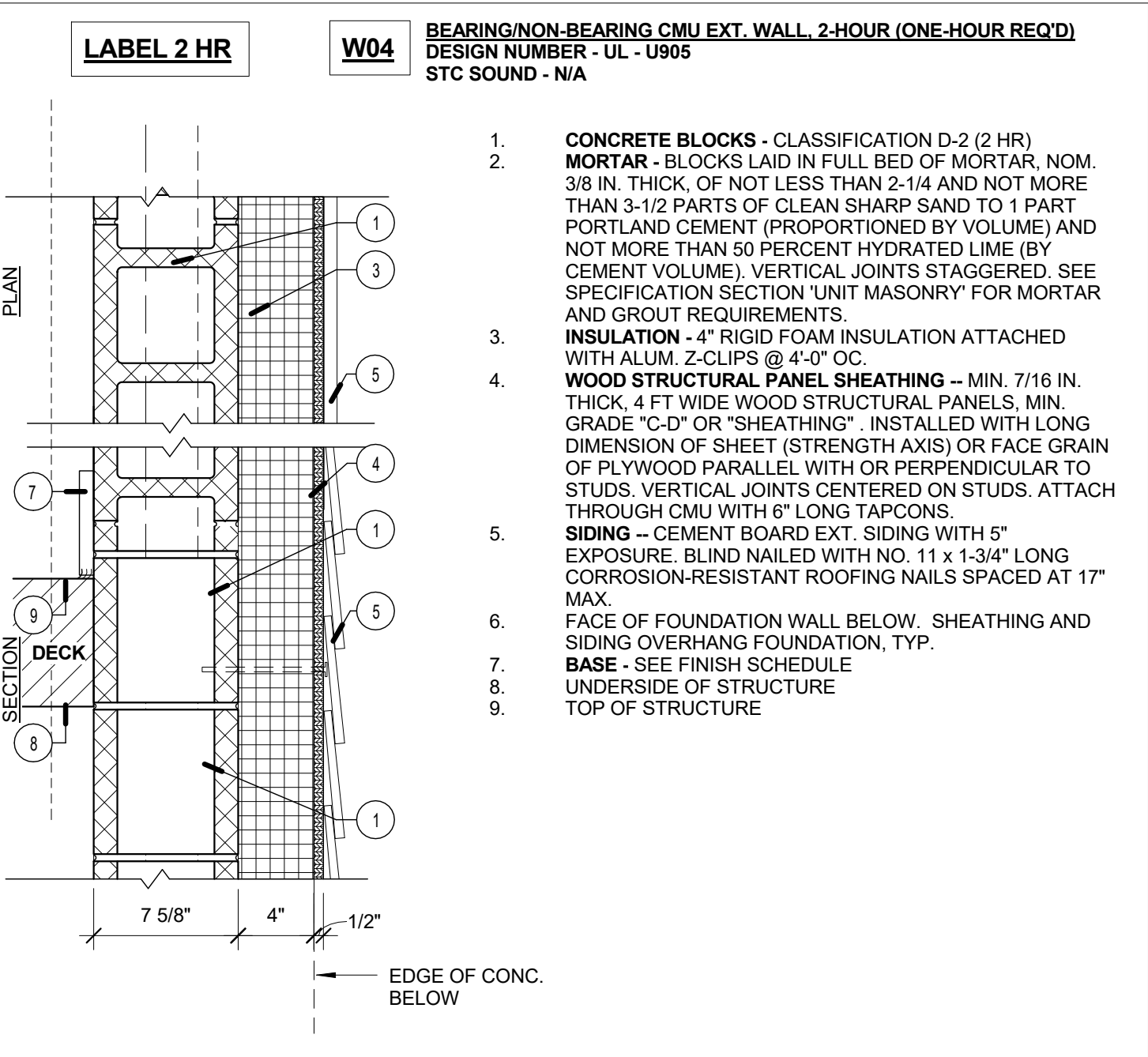

**4 | WALL 04 - CMU WALL/FIBER CEMENT CLAPBOARD**  
1 1/2" = 1'-0"



**9 | WALL 09 - 1 HR LOADBEARING WALL**  
1 1/2" = 1'-0"

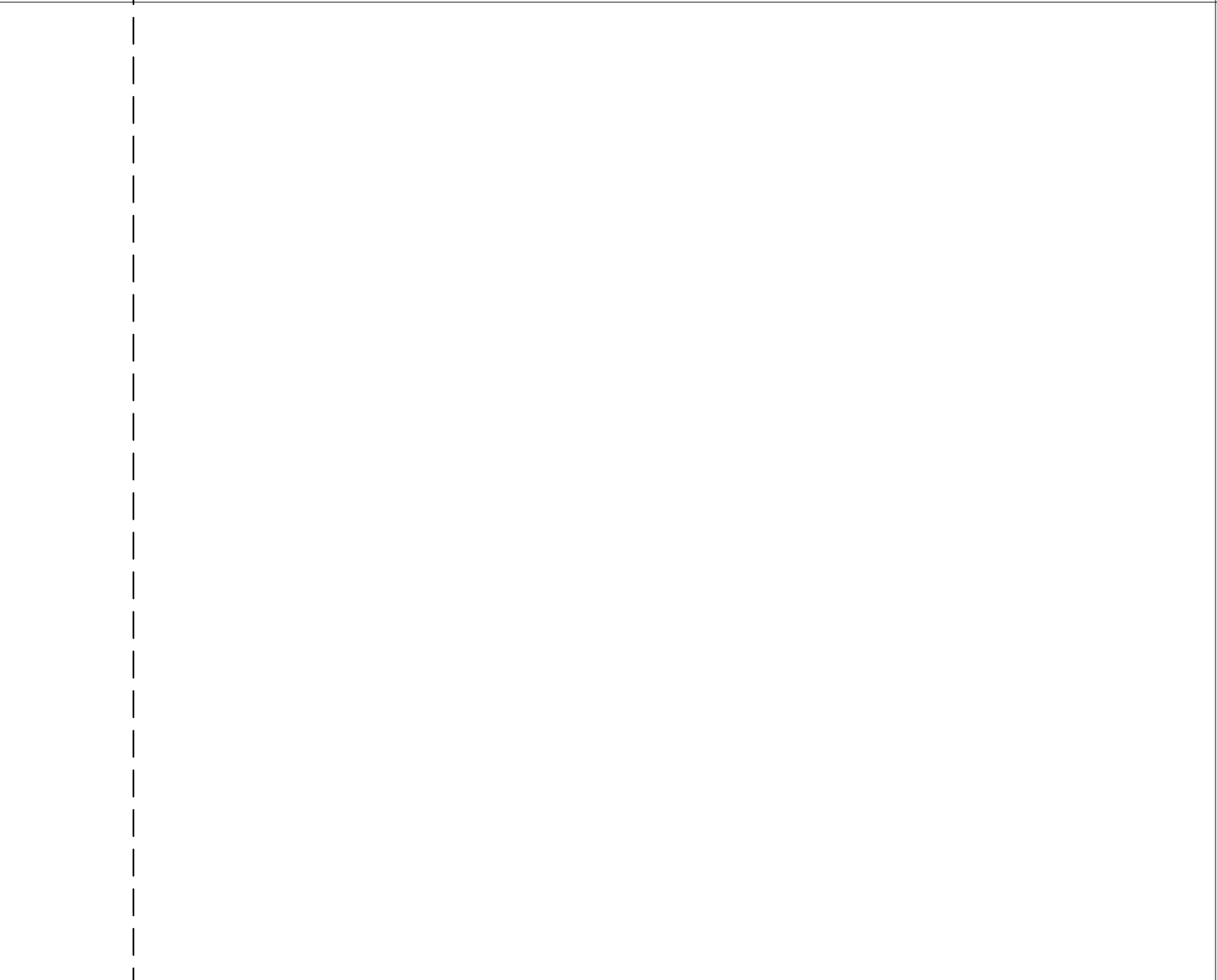

**8 | WALL 08A&B - NON-RATED ONE-SIDED PARTITION**  
1 1/2" = 1'-0"

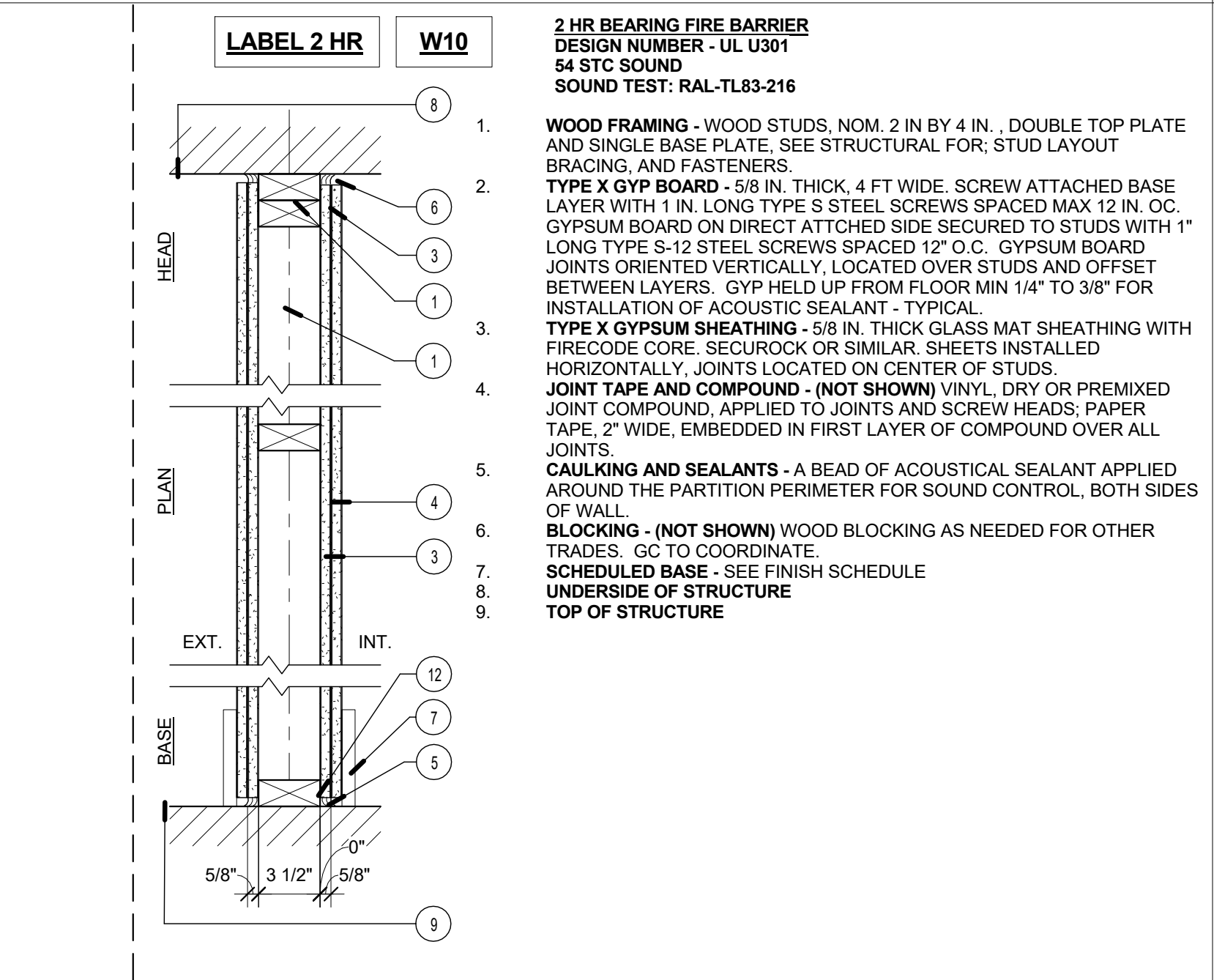

**10 | WALL 10 - 2-HR. BEARING WALL**  
1 1/2" = 1'-0"

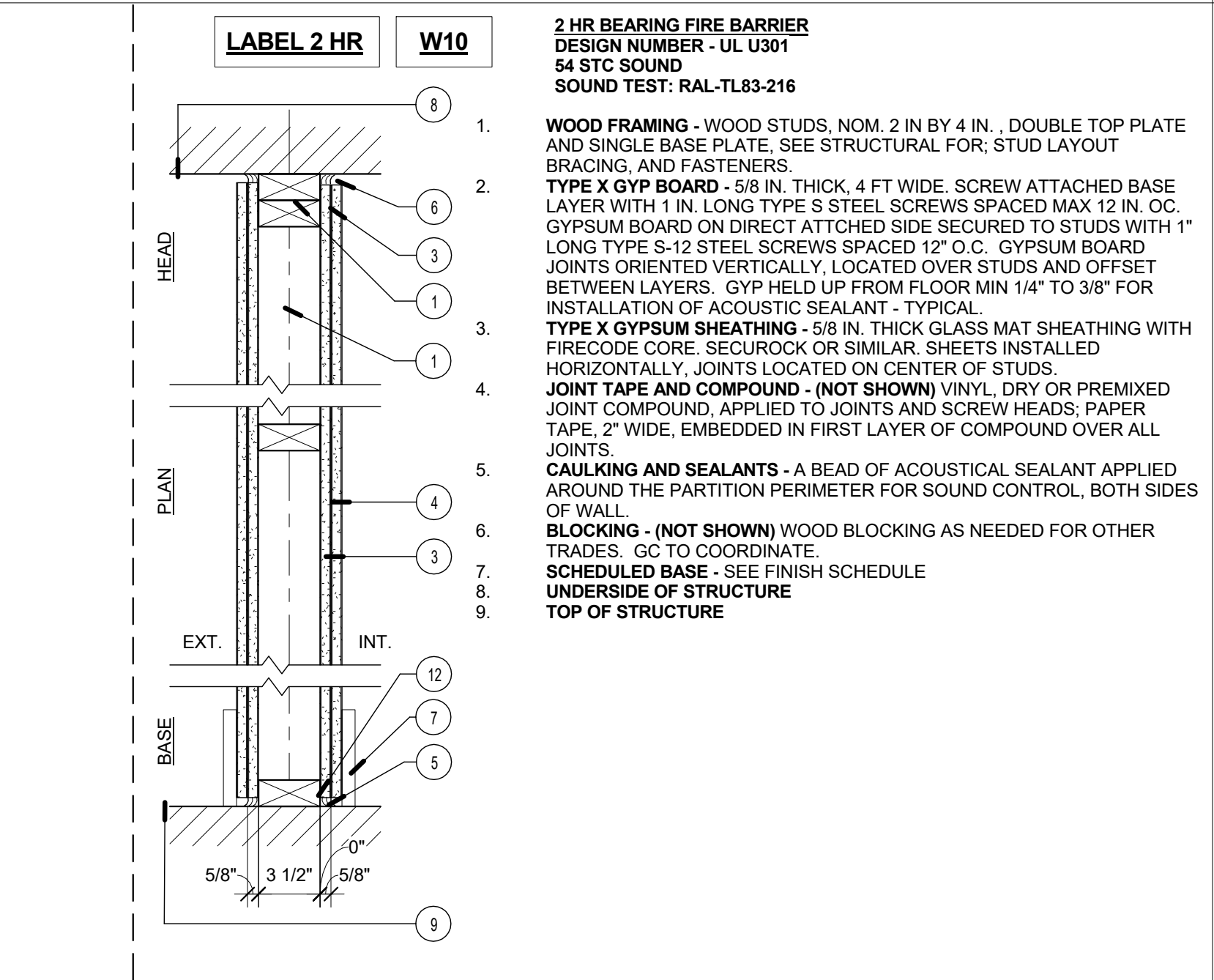

**4 | WALL 04 - CMU WALL/FIBER CEMENT CLAPBOARD**  
1 1/2" = 1'-0"

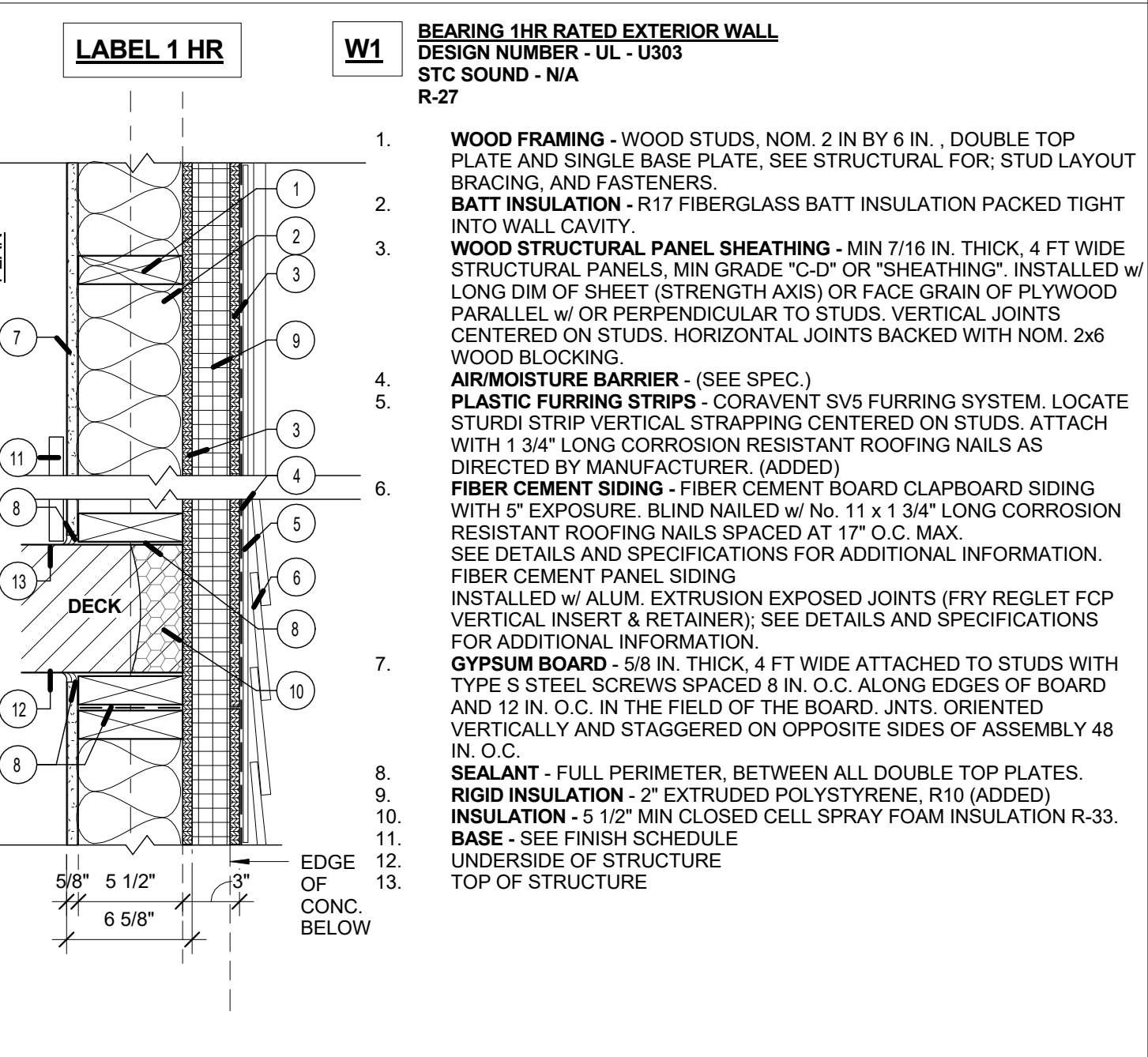

**1 | WALL 01 - FIBER CEMENT PANEL/CLAPBOARD**  
1 1/2" = 1'-0"

Prepared For:  
Westbrook Development  
Corp. & Millbrook Estates  
LLP  
30 Liza Harmon Drive  
Westbrook, ME 04092

Consultant:  
**ARCHETYPE**  
architects  
48 Union Wharf Portland, Maine 04101  
207.772.0022 ARCHETYPE@ARCHETYPEPA.COM

Project:  
**MILLBROOK ESTATES**  
300 East Bridge Street  
Westbrook, ME 04092

Revisions:  
Scale: 1 1/2" = 1'-0"  
Date: 10 AUG 2015  
**WALL TYPES**

**A4.00**