



HARRIMAN

AUBURN PORTLAND PORTSMOUTH BOSTON

**CENTRAL MAINE
COMMUNITY COLLEGE
ECE AREA RENOVATION**

AUBURN, MAINE

Harriman Project No. 16611

Key Plan Proj North

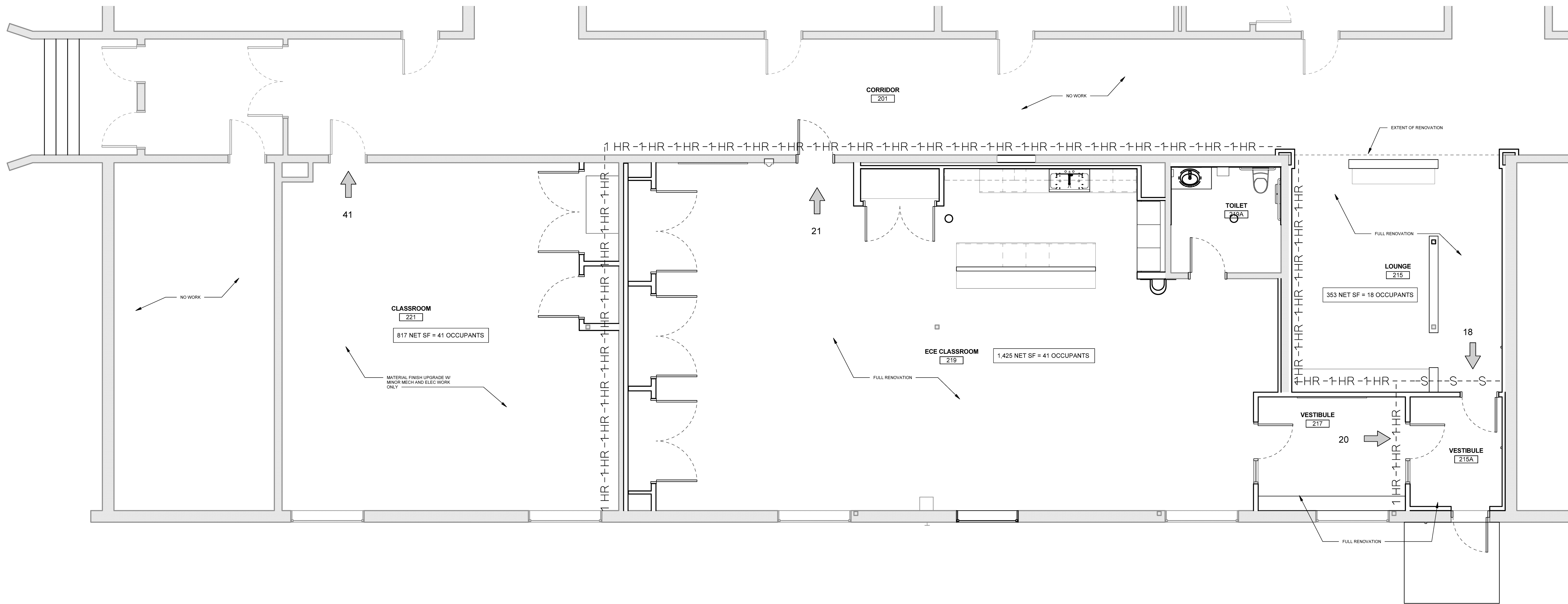
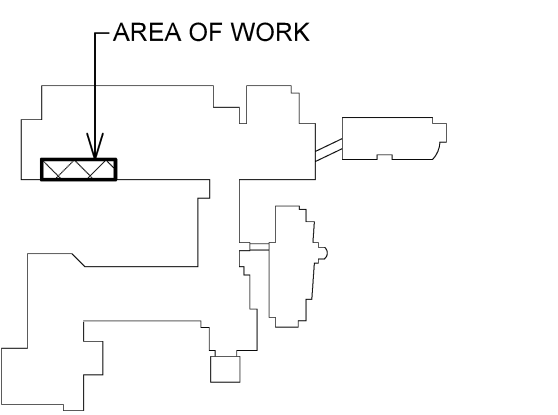

B1 FIRST FLOOR CODE PLAN
SCALE: 1/4" = 1'-0"

CODE COMPLIANCE		SEPARATION REQUIREMENTS
BUILDING DESIGN CODES: AMERICANS WITH DISABILITIES ACT (ADA) NFPA 101 LIFE SAFETY CODE / 2009 INTERNATIONAL BUILDING CODE / 2009 STATE OF MAINE INTERNAL PLUMBING CODE / 2009 INTERNATIONAL ENERGY CONSERVATION CODE / 2009 INTERNATIONAL MECHANICAL CODE / 2009 ASHRAE / IES STANDARD 90.1 - 2007 NFPA 70 NATIONAL ELECTRIC CODE / 2014	BUILDING HEIGHT: ACTUAL: 13'-0" @ CLASSROOMS ALLOWABLE: 75'-0" PLUS SPRINKLER INCREASE FIRE SUPPRESSION: FULLY SPRINKLED SUPERVISED SYSTEM FIRE ALARM: MONITORED FIRE ALARM SYSTEM	DENOTES SMOKE WALL ASSEMBLY DENOTES 1 HOUR FIRE RATED WALL ASSEMBLY
BUILDING AREA: ALLOWABLE (IBC) BUSINESS OCCUPANCY BASE: 23,000 SF ACTUAL CLASSROOM RENOVATION: 2,950 SF	FIRE SEPARATION: 1 HOUR WITH INSTALLED SPRINKLER SYSTEM MEANS OF EGRESS: MAX TRAVEL WITH SPRINKLER: IBC: 200 NFPA: 250 COMMON PATH OF TRAVEL: IBC: 75 NFPA: 75 DEAD END CORRIDOR: IBC: 20 NFPA: 20	
OCCUPANCY CLASSIFICATION: NFPA BUSINESS (CHAPTER 39) DAYCARE (CHAPTER 17) IBC BUSINESS EDUCATION (DAYCARE)		
OCCUPANCY LOADS (PER PERSON): CLASSROOM: 20 SF NET DAYCARE: 35 SF NET		
CONSTRUCTION TYPE: NFPA TYPE II (000) IBC TYPE IIB		
NUMBER OF STORIES: ACTUAL: 1 ALLOWABLE: 3 WITH SPRINKLER INCREASE		

A1 CODE SUMMARY
SCALE: 1/16" = 1'-0"

Issues and Revisions	
Date	Description
03-29-17	CONSTRUCTION DOCUMENTS

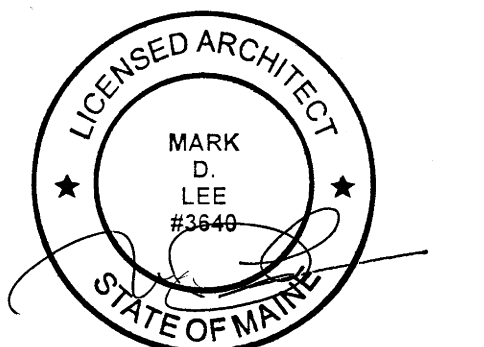

PA/PE: MDL
 Drawn By: MCM
 © 2017
 Harriman Associates

FIRST FLOOR CODE PLAN

A01.1